

LAND CERTIFICATE NO. 53905 COPY

Land Certificate No. 53905 Tulcea

A. Part I. Property description LAND

within the built-up area

Address: Loc. Tulcea, Str Banatului, Jud. Tulcea

Item no.	Cadastral number Topographic number	Surface* (sqm)	Observations / References
A1	53905	From the documents: 2,150 Measured: 2,024	Unfenced land;

B. Part II. Owners and documents

Entries regarding property rights and other real rights		References
106126 / 25/08/2023		
Administrative Act no. 125, dated 23/08/2023 issued by TULCEA LOCAL COUNCIL, annex to HCL (Local Council Decision) no. 125/2001; Administrative Act no. 1360, dated 27/12/2001 issued by the GOVERNMENT OF ROMANIA, annex to GD no. 1360/2001; Administrative Act no. 11827, dated 10/08/2023 issued by TULCEA TOWN HALL; Administrative Act no. 59, dated 25/02/2021 issued by TULCEA LOCAL COUNCIL, annex to HCL (Local Council Decision) no. 59/2021;		
B1	Tabulation, PROPERTY right, acquired by law, current share 1/1, initial share 1/1	A1
	1) TULCEA MUNICIPALITY, CIF (Fiscal Identification Code): 4321429, public domain	

C. Part III. ENCUMBRANCES.

Entries regarding dismemberment of property rights, real rights of guarantee and encumbrances	References
NOT EXISTING	

Annex No. 1 To Part I

Land

Cadastral no.	Surface (sqm)*	Observations / References
53905	From the documents: 2,150 Measured: 2,024	

* The surface is determined in the Stereo 70 projection plane.

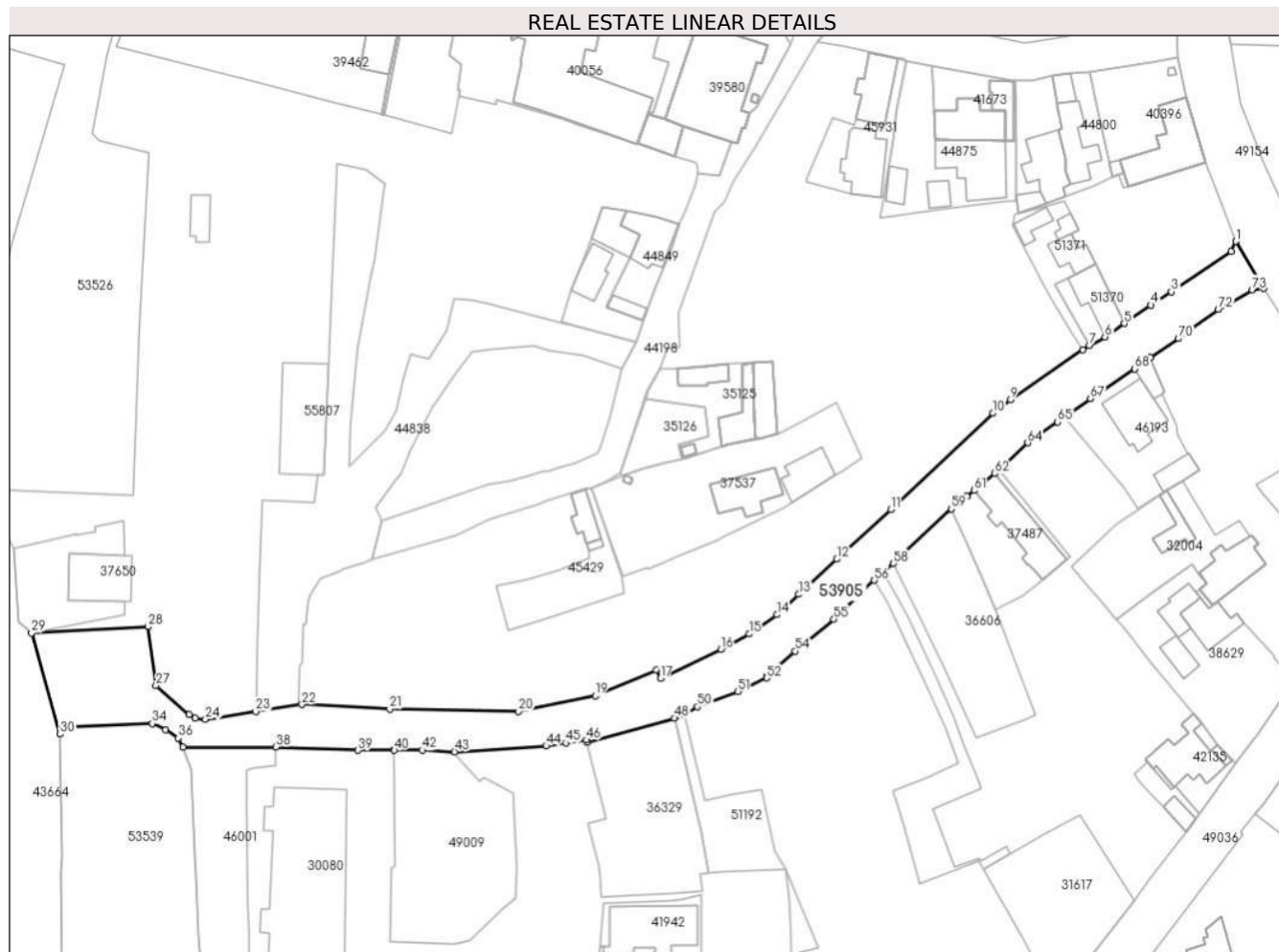

Land related data

Item no.	Usage category	Land within the built-up area	Surface (sqm)	Strip land	Lot	Topographical no.	Observations / References
1	road	YES	2,024	-	1	-	STREET ROAD

Segments length

1) The segment length values are obtained from the plan projection.

Start point	End point	Segment length	Start point	End point	Segment length	Start point	End point	Segment length
1	2	1.97	2	3	13.01	3	4	4,428
4	5	5,767	5	6	4,254	6	7	3,202
7	8	1.43	8	9	15,834	9	10	3,992
10	11	25,205	11	12	13,219	12	13	9,307
13	14	5,399	14	15	6,079	15	16	5,788
16	17	12,051	17	18	1,665	18	19	11,928
19	20	14,073	20	21	23,215	21	22	15,797

Start point	End point	Segment length	Start point	End point	Segment length	Start point	End point	Segment length
22	23	8,389	23	24	9,155	24	25	1,861
25	26	1,293	26	27	7,904	27	28	10,671
28	29	20.97	29	30	18,903	30	31	0,984
31	32	0,333	32	33	0,559	33	34	15,407
34	35	2,595	35	36	2.73	36	37	1,782
37	38	16,744	38	39	14,705	39	40	6,612
40	41	0.17	41	42	5,042	42	43	5,797
43	44	16,503	44	45	3,613	45	46	3,678
46	47	0,431	47	48	16,301	48	49	1,926
49	50	2.76	50	51	7,699	51	52	5,798
52	53	0,357	53	54	6,835	54	55	9,007
55	56	10,113	56	57	2.2	57	58	2,367
58	59	14,373	59	60	3.61	60	61	1,645
61	62	4.8	62	63	1,002	63	64	7,087
64	65	6,586	65	66	1,513	66	67	5,722
67	68	9,605	68	69	3,431	69	70	6,182
70	71	2,766	71	72	6,118	72	73	6,999
73	74	2,089	74	1	9,862			

** Segment lengths are determined in the Stereo 70 projection plane and are rounded to 1 millimeter.

*** The distance between the points is made up of cumulative segments that are smaller than the value of 1 millimeter.